



龙星全提花织领机

FULL JACQUARD COLLAR KNITTING MACHINE

LX1132F/SCE131F



LX1132F/SCE131F

创新设计的全提花织领机，由伺服控制驱动，具有自动六色换纱、自动调节密度等功能，直选式选针系统结合专业的织领机针结构设计，能够满足高品质提花织领的高效生产需求。

This is an innovative design of full jacquard collar knitting machine, which is driven by servo motor and it has 6 yarn feeders with automatic change, automatic density adjustment and other functions, direct needle selection system combined with structural design of professional collar knitting machine ,it can meet the production demand of high-quality and high -efficiency Jacquard collar knitting machine.



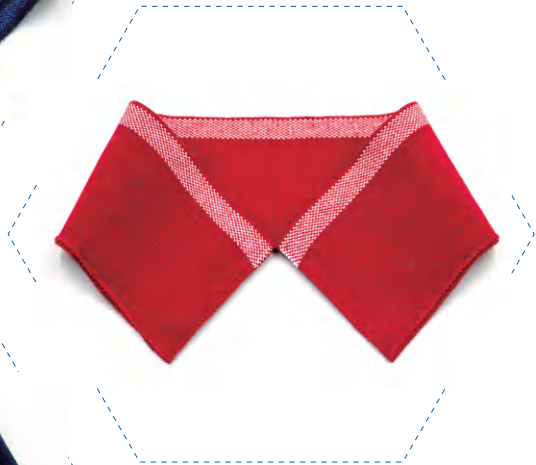

采用LED触摸屏，可显示各种编织相关参数

LED touch screen for displaying various knitting related parameters



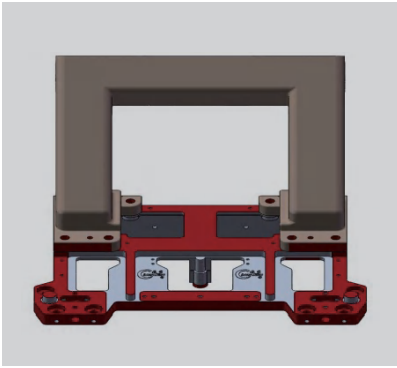

采用直选针系统，搭配精巧机头，机器运行更经济高效

With a directly needle selection system, small carriage, makes the machine more effective

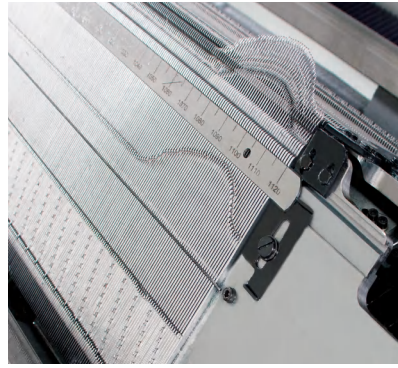

精密织针与八段选针系统配合设计，针板高频淬火处理，能满足高品质衣领织物的生产需求

Precision needle and 8-segment needle selection system, and the needle plate is quenched by high frequency to meet the production requirements of high-quality collar fabrics.

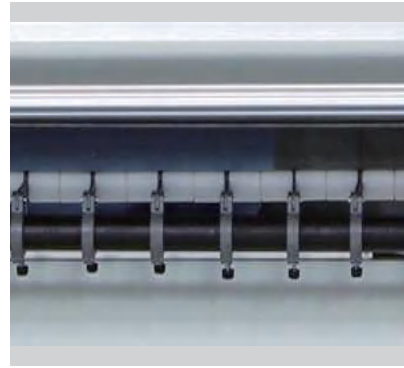

采用加大加粗卷布轮设计，充分满足双面组织对牵拉力的更高要求以及增强牵拉的平稳性能

The use of the increased thickening fabric winding roller design fully meets the higher requirements of the double-sided organization on the drawing force and enhances the smooth performance of the drawing.



产品参数

Model 机器型号	LX1132	SCE131A
Basic parameters 基础参数	● Standard configuration	○ Optional — Without
Gauge 针型	12G/14G/16G/18G	
Carriage 机头数量	1	1
Knitting system 编织系统	1 SYSTEM	1 SYSTEM
Width (INCH) 宽度 (英寸)	52	52
Inset needle bed 插片针板	○	○
Running speed (M/S) 运转速度 (米/秒)	1.4	1.4
SMALL Carriage 小机头	●	●
Probe 探针	●	●
Motor transfer 马达翻针	—	●
Machine two side tool box 两边工具箱	—	—
Cleaning system 清洁系统	—	—
Motor driving selection JACK raise cam 马达换向	—	—
Needle bed racking 针板摇床	±1inch	±1inch
Sinker 信克	—	—
Lubrication system (auto, manual, none) 润滑系统 (自动、手动、无)	—	—
Tight tuck 紧吊目	—	—
Dynamic density 可变量目	●	●

Model 机器型号	LX1132	SCE131A
Take down device 牵拉系统	● Standard configuration	○ Optional — Without
Rubber roller 皮罗拉	○	○
Auto down roller 自动开合下罗拉	—	—
Manual down roller 手动开合下罗拉	●	●
Comb 起底板	—	—
Wire comb 无废纱起底	—	—
Scissors 剪刀夹子	—	—
Yarn device 喂纱装置	● Standard configuration	○ Optional — Without
Top tension 天线台数量	12 PCS	12 PCS
Lycra feeder 氨纶送纱器	●	●
Yarn storage device 储纱器	—	—
Yarn supplier device 送纱器	●	●
Yarn carrier 纱嘴	● Standard configuration	○ Optional — Without
Carrier quantity 纱嘴数量	12 PCS	12 PCS
Auto motor-driven carrier 智跑纱嘴	—	—
Up-and-down motion carrier 自动上下纱嘴	—	—
Weft insetion carrier 衬纬纱嘴	—	—
Ultra-wide adjustable carrier (34-47mm) 超宽可调节纱嘴 (34-47毫米)	—	—
Double holes 双孔纱嘴	○	○

Model 机器型号	LX1132	SCE131A
Safty device 安全装置	● Standard configuration	○ Optional — Without
Emergency stop devices 紧急停车装置	●	●
Safty cover with infrared ray 护罩红外感应	●	●
Power cut off device 断电记忆	●	●
Alarm device 报警装置	● Standard configuration	○ Optional — Without
Fabric rewind alarm (infrared ray) 布片倒卷报警（红外线）	●	●
Fabric rewind alarm (detection board) 布片倒卷报警（倒卷板）	—	—
Needle crash alarm 撞针报警	●	●
Yarn breakage alarm 断纱报警	●	●
Yarn knot alarm 纱结报警	●	●
Stroke protection device (racking) 摇床限位报警	●	●
Stroke protection device (carriage) 机头限位报警	●	●
Over load alarm 过载报警	●	●
Knit piece finish alarm 编织件数完成报警	●	●
Sepecific row stop 指定行停车	●	●
Program error 程序错误	●	●
Power 电源	● Standard configuration	○ Optional — Without
AC 220V ± 5%(1phase 50/60Hz) 单相220V、50/60HZ	●	●
AC 380V ± 5%(3phase 50/60Hz) 三相380V、50/60HZ	○	○
Power consumption 功率	1.0KW	1.0KW

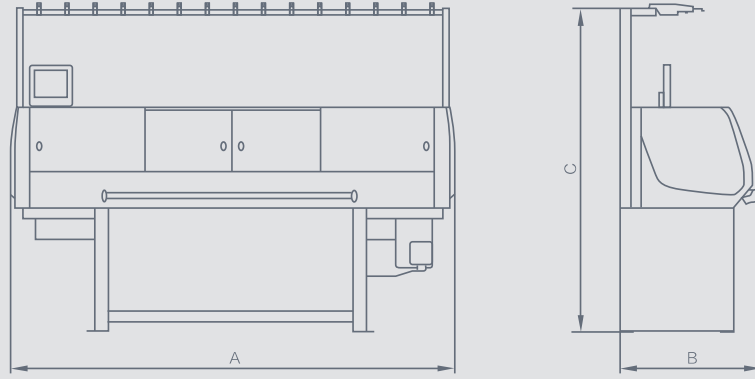

机器型号 MACHINE MODEL	外形尺寸(毫米) BOUNDARY DIMENSTON(mm)	包装尺寸(毫米) PACKAGE DIMENSTON(mm)	净重(kg) NET WEIGHT(KG)	毛重(kg) GROSS WEIGHT(KG)
	长 × 宽 × 高(A×B×C) LENGTH×WIDTH×HEIGHT(A×B×C)	长 × 宽 × 高 LENGTH×WIDTH×HEIGHT		
LX1132	2435×815×1850	2650×1050×1820	565	730
SCE131A	2435×815×1850	2650×1050×1820	565	730

苏州梵洲科技有限公司

SUZHOU FANZHOU TECHNOLOGY CO.,LTD

江苏省常熟市阳光大道8号
No.8 Yangguang Road,Changshu City, Jiangsu, China

电话 T +86-15250337092

传真 F +86-15250337092

邮箱 E Juanschuan@gmail.com

Website: www.fanzhoultd.com

Whatsapp: +86-15250337092



Website



Wechat



Whatsapp